

# Infrastructure & Operations

## REQUEST FOR CONSTRUCTION

Lantz Wastewater Infrastructure Replacement  
RFC50584  
Addendum 2

Release date: June 14, 2023

**Tenders will be received up to**  
2:00:00 pm local time on Friday, June 16, 2023

Contact: Michael Hatfield  
Procurement Officer  
Municipality of East Hants  
Telephone: (902) 883-6232  
Email: [mhatfield@easthants.ca](mailto:mhatfield@easthants.ca)



**EAST HANTS**  
**We live it!**

## PREFACE

THESE PROJECT DOCUMENTS HAVE BEEN PREPARED FOR USE WITH AND REQUIRE BEING READ IN CONJUNCTION WITH THE **STANDARD SPECIFICATION FOR MUNICIPAL SERVICES** AS PUBLISHED BY THE NOVA SCOTIA ROAD BUILDERS' ASSOCIATION - CONSULTING ENGINEERS OF NOVA SCOTIA **JOINT COMMITTEE ON CONTRACT DOCUMENTS**. COPIES OF THE STANDARD SPECIFICATION ARE AVAILABLE FROM THE JOINT COMMITTEE ON CONTRACT DOCUMENTS, 18 LAURIER STREET, DARTMOUTH, NOVA SCOTIA B3A 2G7; TELEPHONE: (902) 233-9362 OR e-mail at [nsmunicipalservices@gmail.com](mailto:nsmunicipalservices@gmail.com)

## CORRECTIONS/CLARIFICATIONS

Following release of the Request for Construction for this project, East Hants received the 'Work Within Highway Right-of-Way Permit' from Nova Scotia Public Works (NSPW). The permit has been attached to this addendum for informational purposes.

Additionally, East Hants has received the following questions:

1. *"With regards to this project, you have not provided any details concerning the existing dual 150 forcemains that discharges into EMH 90 that we are to replace. All you state in the tender document is that we are to maintain flows and provide bypass pumping. Please provide a detailed scope of work that is required to carry out the maintenance of flows and bypass pumping for the dual 150mm forcemains."*
2. *"With regards to section J on drawing 10, the cross section depicting typical road reinstatement, you show surge below the gravels but you do not indicate to what thickness we are to install surge. Are we to assume the entire trench is to be completely backfilled with surge rock?"*
3. *"Also concerning my email below, the note on the same cross section "ex. Road width to be reinstated" do you want the entire roadway where there is asphalt present is to be reconstructed to this cross section? If so what pay items is this work to be covered under as there are no items for gravels/surge or asphalt although there is a subtotal on page 5 of the tender form for street construction. Also there is a note below the detail that indicates the gravel road is to also be reconstructed. Does this mean you want the entire gravel road reconstructed? Please clarify to what extend trench reinstatement vrs street reconstruction is to take place."*

Regarding the above questions, East Hants provides the following responses:

1. Record drawing information for the forcemain replacement could be provided along with existing pump details. If the pumps are operated one at a time, this information would also be useful as well. This should be sufficient for the contractor to prepare a bypass strategy.
2. Trench backfill is to be in accordance with Detail A/10. Replace 'Surge' in Detail J/10 with 'Surge - in locations and thicknesses directed by project geotechnical engineer.' Surge is intended to be provisional as noted in the tender documents, and would only be used if necessary.
3. Reinstatement is included in all items through General 3.3 in Section 01 22 00, and must be reflected in the corresponding unit rates. The sanitary main removal and replacement is expected to significantly impact the asphalt surface on Green Road Extension; therefore, full reinstatement for this section should be assumed. Regarding

the gravel road, full width reinstatement would only be required if the entire road width is disturbed.

Logan Blanchard  
Municipality of East Hants  
15 Commerce Court  
Elmsdale, NS B2S 3K5

May 31, 2023

**Re: Work Within Highway Right-of-Way Permit #04956; Green Road Extension, Lantz**

Dear Mr. Blanchard:

The proposed wastewater infrastructure replacement project at Green Road Extension and Highway 2, Lantz is acceptable to this Department. The following terms and conditions constitute part of Department of Public Works (DPW) Permit #04956:

1. The work shall be conducted in accordance with the attached drawing set *Lantz Wastewater Infrastructure Replacement* Revision 2, Dated December 19, 2021
2. All work undertaken shall be in conformance with the *Work Within Highway Right-of-Way Permit* and all applicable conditions detailed in section 8. All other pertinent provincial and municipal permitting is the responsibility of the permit holder and shall be adhered to.
3. Traffic Control and Hours of Work
  1. Traffic control is the responsibility of the Permit Holder and shall comply with the *Nova Scotia Temporary Workplace Traffic Control Manual* (latest edition), as revised from time to time.
  2. Traffic control is permitted during specific hours depending on the plan being used. Any proposed traffic control at night requires DPW approval in advance; additional traffic control plans and other measures are required for night work.
  3. Traffic control plans and all lane closures are to be approved by DPW in advance. At no time during the work shall traffic be limited to less than one lane.

4. Traffic control set-up must be established by an accredited Temporary Workplace Signer and all Traffic Control Persons must have a valid TCP Certification, available on-site at all times.
5. Traffic control configurations and/or lane closures may be limited to certain days of the week and certain times of day, as determined by DPW. These limitations may be modified by DPW at any time in the interest of public safety.
6. Work shall be carried out in such a manner to minimize delays to road users. The maximum allowable delay as a result of traffic control shall be ten (10) minutes. During times of peak traffic, the Permit Holder may be required to cease work activities and restore normal traffic operations until traffic volumes permit resuming, as directed by DPW.

#### 4. Excavation and Finished Road Surface

##### Backfill:

- Fill material must be approved by DPW
- All stones in the backfill must be less than 50mm in dimension.
- Backfill must be compacted in layers of 160mm or less and compacted to 95% of standard proctor density. The applicant will provide compaction testing results conducted by a qualified technician.
- The structural gravels must be crushed aggregate and shall meet DPW standard spec Div. 3 Sec. 2 with depths of:
  - 150mm Type 1 gravel
  - 300mm Type 2 gravel

##### Paving:

- Repave immediately unless approved otherwise by the Area Manager. If a delay is permitted, the surface of the backfilled excavation must be maintained by the applicant to the satisfaction of the Area Manager until repaving is completed.
- The new & reinstated asphalt structure must be placed with a base lift of 75mm of type B-HF followed by a surface lift of 50mm type C-HF. Asphalt mix shall conform with DPW standard spec Div. 4 Sec. 19.
- Surface course of asphalt must be placed at a minimum width of 1 full lane. Key joints (saw cut/cold cut planed) will be required along all edges.

Please be advised the contractor shall contact DPW's Milford Base at 1-844-696-7737 at least 48 hours before breaking soil within the ROWs of Green Road Extension and Hwy. 2.

5. It is the responsibility of the permit holder to identify any underground or above ground utilities and obtain any necessary approvals from third parties.
6. All work shall be conducted in accordance with the Province of Nova Scotia's Occupational Health and Safety Act and Regulations.
7. The Province shall not be liable for any damages or injury as a result of the work undertaken relating to this permit. Any and all insurance premiums, deductibles, and necessary claim handling and settlement is the responsibility of the applicant and certified copies of insurance documents evidencing Commercial General Liability are to be provided to the undersigned within ten business days upon request. Damages or issues resulting from this work shall be the responsibility of the permit holder and repaired/addressed accordingly to the satisfaction of the Area Manager.

Should you have any questions or concerns regarding this permit or these conditions please contact me at 902-798-2369.

Yours truly,

A handwritten signature in blue ink, appearing to read "Patrick", followed by a long horizontal flourish.

Patrick Lemal, P.Eng.  
Area Manager Hants

PL/cas

MAR 14 2023

## Public Works

Public Works  
Area Office - Windsor, NS

## Work Within Highway Right-of-Way Permit

**Who needs this permit?** If you are planning any activity / work on the roadway or within the highway right-of-way, including installing a driveway or erecting a structure within 100 metres of any highway, a permit is required prior to starting the work. Please read the "Information for Work Within Highway Right-of-Way Permit" brochure (brochure) before completing this application.

## For Staff Use Only

Permit Approved ☒ (Check here)Permit Denied ☐ (Check here)

Permit #: 04956

Deposit Receipt #: 28488

Deposit Amount: \$50,000.00

Permit Valid until: MAY 31 2024

## 1 Applicant Information (please print)

Name: Logan Blanchard

Mailing address: 15 Commerce Court, Elmsdale, NS, Canada

Postal code: B2S 3K5

Daytime phone number: (902) 883 - 6227 Email address: lblanchard@easthants.ca  
(if applicable)

## 2 What type of work will you be doing by the roadside? (check all that apply)

☒ Access to a public highway/roadway for the purpose of: ☒ Sewer ☒ Water ☐ Cable ☐ Driveway ☐ Other \_\_\_\_\_☒ Work will disturb existing road surface. If so, what type? ☒ Asphalt ☐ Concrete ☒ Gravel ☐ Other \_\_\_\_\_☐ Building a structure within 60 metres of the limit of a controlled access highway☐ Building a structure within 100 metres of centerline of a public highway/roadway

## 3 Check type of structure or access you require. If not applicable, go to number 4

☐ Residential ☐ Agricultural ☐ Commercial ☐ Industrial ☐ Recreational ☐ Institutional ☐ Other \_\_\_\_\_

## 4 Give enough information so our staff can find your property (complete as much as possible)

Name of subdivision: Please refer to the attached drawing set. Name of lot owner: \_\_\_\_\_

Civic or lot number: \_\_\_\_\_ Property ID #: (if known) \_\_\_\_\_

Name of community: Lantz in Hants County

Name of highway/roadway: Green Road Extension on the ☐ North ☐ South ☒ East ☐ West side of highwayApproximately \_\_\_\_\_ km's \_\_\_\_\_ of \_\_\_\_\_  
(Distance) (NSWE) (Bridge or any defined point on Highway)

GPS Coordinates: (if known) \_\_\_\_\_ N \_\_\_\_\_ E

Distance of nearest part of structure to centerline of highway is \_\_\_\_\_ metres

Number of lots to be serviced by this access is \_\_\_\_\_

Distance from centerline of highway to sewer, well, spring, etc. is \_\_\_\_\_ metres



## 5 Complete a sketch on Page 3

☐ Sketch completed Please refer to the attached drawing set.

☐ Yes ☐ No Preferred driveway location been marked (staked) on your property.

## 6 Check how you would like to receive your permit approval

☐ by mail

☐ by fax at fax number \_\_\_\_\_

☒ by email at lblanchard@easthants.ca

☐ I will pick it up at the local office

## 7 Provide a certified cheque, money order or bank draft for the deposit amount

Call the local office to find out the deposit amount you have to pay. Please refer to the "Information for Work Within Highway Right-of-Way Permit" brochure to find out more about Deposit information and to find the office nearest you. Deposits are to be paid by a certified cheque, money order or bank draft only and made payable to the Minister of Finance.

## 8 Sign the certification

I certify that:

1. I have read and understand the "Information for Work Within Highway Right-of-Way Permit" brochure.
2. DPW shall not be held liable for any personal injury and/or property damage of any kind whatsoever, which may arise both during and after the completion of the work covered by this permit, where, in the opinion of DPW, such injury or damage arises as a result of the work, including disturbance of regulatory signs.
3. I am responsible for and will bear all costs associated with any pipe(s), cable(s) or any damage to any other DPW installations whenever required by DPW. Relocation of pipes, cables, etc., is dependent on what type of work is being done.
4. (a) I am responsible for and will bear all costs during the work in connection with the following:  
i) all claims for damages due to accidents; ii) direction of traffic, including barricades, lights, signs and supply of properly equipped and qualified Traffic Control Persons; iii) protection of all traffic according to the *Nova Scotia Temporary Work Place Traffic Control Manual* (refer to Condition #3 in the brochure for more information about this manual); iv) maintaining road surface and ditches adjacent to this project; and v) all inspection charges.  
(b) Both during the work and after approval of the work, I am responsible for and will bear all costs in connection with the following: erection, maintenance, removal or falling of regulatory signs both during and after the erection or installation of the sign, sign structure or part thereof.
5. The information given by me in this application is complete and accurate and I agree to all the Conditions as outlined in the brochure, all special conditions that may be outlined in Section 13 of this permit and all conditions that may be outlined if a cover letter is attached. I will ensure that all Conditions as specified by DPW are met.
6. I am the owner of the property at the location to which this permit applies. ☒ Yes ☐ No (If you answered no and you are not the property owner, please provide permission in writing from the property owner for the access you require.)

Name (please print): Logan Blanchard

Signature: \_\_\_\_\_



Date: 2023/03/14

## 9 Return the application and any attachments to your local office

1. Refer to the brochure for a list of addresses and phone numbers for all of Nova Scotia's local offices.
2. If you have any questions, please call the local office nearest you.

## 10 Call the local office before starting work

Call the number below before starting the work. The local office will provide this information.

Call \_\_\_\_\_ hours before starting work.

## 11 Call the local office for inspection

Call the number below when you are ready for inspection. The local office will provide this information.

After work is completed, call \_\_\_\_\_ Please have your permit number handy when you call. Permit number is found on the front page (top right hand corner of this permit).

## 12 Draw a sketch

Please refer to the attached drawing set.

Please sketch a lot showing location of driveway & building, including dimensions.

## 13 Special Conditions

---

---

---

---

---

### To Be Completed By Staff

Road Classification: ☐ Non-controlled Access ☐ Controlled Access\* ☐ Listed and Abandoned\* ☐ Service Road\*

S.S.D. \_\_\_\_\_ metres available Direction: \_\_\_\_\_ Grade: \_\_\_\_\_ S.S.D. \_\_\_\_\_ metres required

S.S.D. \_\_\_\_\_ metres available Direction: \_\_\_\_\_ Grade: \_\_\_\_\_ S.S.D. \_\_\_\_\_ metres required

Checked Using: ☐ 600mm cone ☐ 380mm cone ☐ 150mm cone

Existing Driveway: ☐ Yes ☐ No

Pipe Required: ☐ Yes ☐ No Pipe Inside Dia.: \_\_\_\_\_ mm

Site Checked by: \_\_\_\_\_

Speed Zone: \_\_\_\_\_ km/hr RAS \_\_\_\_\_ km/hr

Special Conditions letter required: ☐ Yes ☐ No

☐ Copy of permit sent to Municipality (if required)

☐ Copy of permit sent to local base (if required)

Comments: \_\_\_\_\_

\_\_\_\_\_

\_\_\_\_\_

*\*review DPW policy prior to issuing permit*

### Approved

In consideration of an application as set forth above for the Work on the Roadside Permit; consent is hereby given, subject to the Conditions outlined in the brochure.

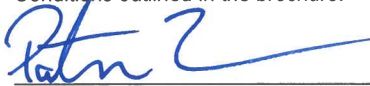

Signature of Area Manager

Date: May 31, 2023

Circumstances will arise that require director or executive level approval. If required, please forward to applicable authority for signature:

Signature of Director

Date: \_\_\_\_\_

Signature of Executive Director Maintenance and Operations

Date: \_\_\_\_\_

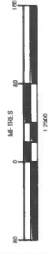
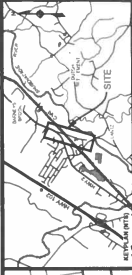

| NO. | DATE         | DESCRIPTION                                | CONSULTANT |
|-----|--------------|--|------------|
| 3   | DRAFT        | ISSUED FOR TENDER                          |            |
| 2   | DEC 18, 2017 | EXTENDED SEWER TO EXISTING PUMPING STATION |            |
| 1   | JAN 18, 2017 | ISSUED FOR REVIEW                          |            |
| 1   |              | ISSUE                                      |            |

**DESIGNPOINT**  
engineering • surveying • solutions  
800 237 2627  
designpoint.ca

CLIENT

**EAST HANTS**

**LANTZ WASTEWATER  
INFRASTRUCTURE  
REPLACEMENT**  
LANTZ, NOVA SCOTIA

SHEET DESCRIPTION

COVER SHEET

|               |                        |                           |             |
|---------------|------------------------|---------------------------|-------------|
| Drawn         | Engineer               | Project No.               | Drawing No. |
| S. HODGSON    | A. SKETCHLEY           | 20-044                    | T-01        |
| Scale: 1:5000 | Project Date: 20/04/18 | Project Name: Lantz WWSIR | 1 of 10     |

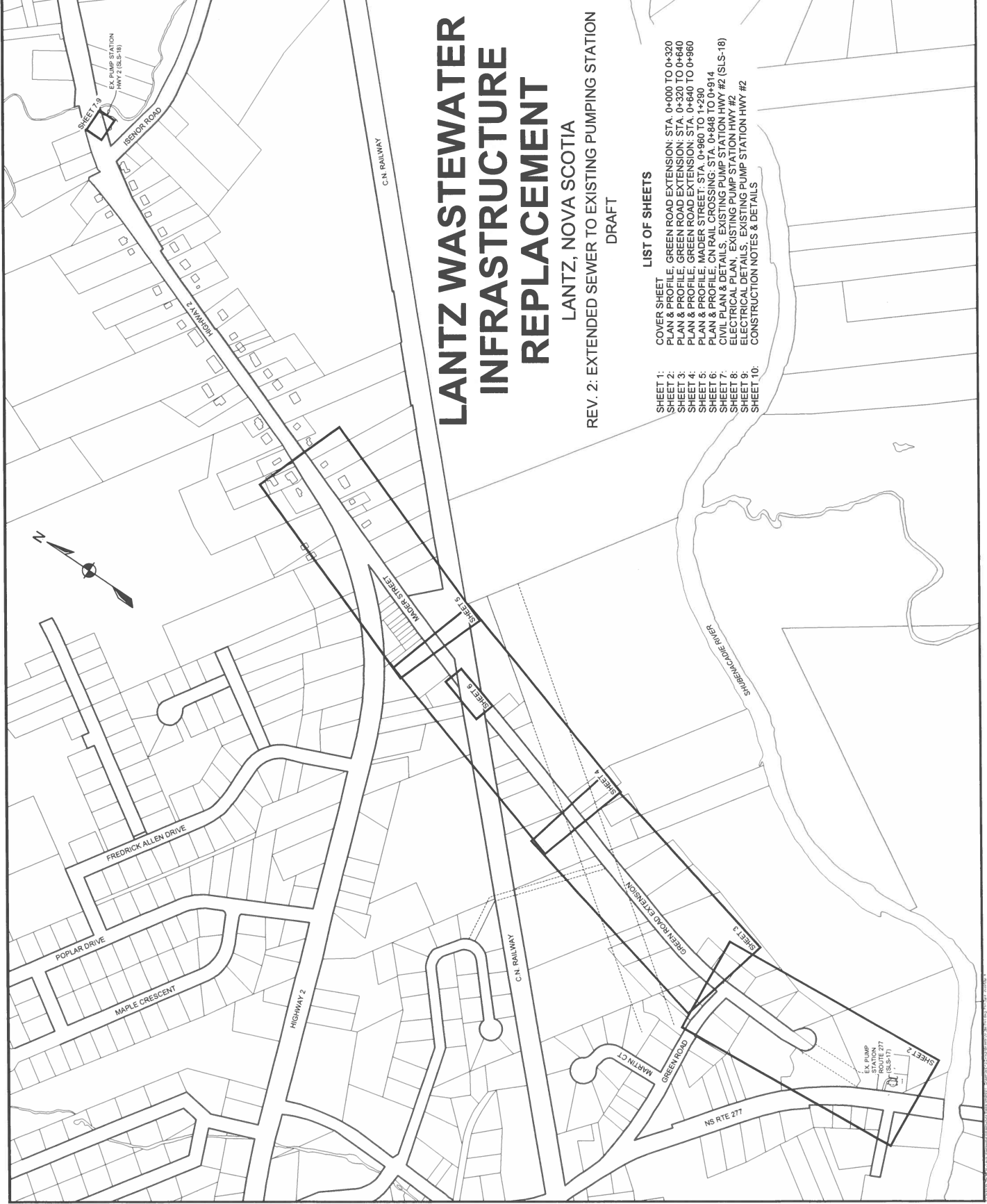

# LANTZ WASTEWATER INFRASTRUCTURE REPLACEMENT

## LANTZ, NOVA SCOTIA

REV. 2: EXTENDED SEWER TO EXISTING PUMPING STATION  
DRAFT

### LIST OF SHEETS

- COVER SHEET
- SHEET 1: PLAN & PROFILE, GREEN ROAD EXTENSION: STA. 0+000 TO 0+320
- SHEET 2: PLAN & PROFILE, GREEN ROAD EXTENSION: STA. 0+320 TO 0+640
- SHEET 3: PLAN & PROFILE, GREEN ROAD EXTENSION: STA. 0+640 TO 0+860
- SHEET 4: PLAN & PROFILE, MADER STREET: STA. 0+960 TO 1+290
- SHEET 5: PLAN & PROFILE, CN RAIL CROSSING: STA. 0+848 TO 0+914
- SHEET 6: CIVIL PLAN & DETAILS, EXISTING PUMP STATION HWY #2 (SLS-18)
- SHEET 7: ELECTRICAL PLAN, EXISTING PUMP STATION HWY #2
- SHEET 8: ELECTRICAL DETAILS, EXISTING PUMP STATION HWY #2
- SHEET 9: CONSTRUCTION NOTES & DETAILS
- SHEET 10:

## Public Works

## Official Receipt / Acknowledgement of Deposit

Location Windsor N.S. May 11 2023

RECEIVED from Municipality of East Hants

Address 230-15 Commerce Court, Elmdale B2S 3K5

in the sum of forty two thousand five hundred and 400 Dollars (\$ 52,500.00 )

in the form of Cash (Cheque)

in connection with Pav Permits 04950 + 04956

CBG  
Area Manager / or

Release Authorized Area Manager / or

Date May 11 2023

## For Department Area Office Use Only

Complete when deposit returned

to depositor: \_\_\_\_\_

Mail to: \_\_\_\_\_

Delivered to: \_\_\_\_\_

Date: \_\_\_\_\_

20

Signature of Area Office Staff

| A  | B | C | D | E | F | G | H | AMOUNT |
|----|---|---|---|---|---|---|---|--------|
| 32 |   |   |   |   |   |   |   |        |
| 32 |   |   |   |   |   |   |   |        |
| 32 |   |   |   |   |   |   |   |        |
| 32 |   |   |   |   |   |   |   |        |

MUNICIPALITY OF EAST HANTS

230-15 COMMERCE COURT  
ELMSDALE, NOVA SCOTIA B2S 3K5  
PHONE (902) 883-2299

Pay to the order of

Vendor: 102731  
MINISTER OF FINANCE  
PO BOX 160 4 IVERY LANE  
WINDSOR NS B0N 2T0

Page 1 / 1  
Cheque 003796  
Date 03052023  
Document 2000002856

| Invoice No.    | Invoice Date | Description            | Invoice Amt | Discount | Payment Amt |
|----------------|--------------|------------------------|-------------|----------|-------------|
| PERMIT DEPOSIT | 04/01/2023   | PROJECT 20-035         | 2,500.00    | 0.00     | 2,500.00    |
| PERMIT DEPOSIT | 04/02/2023   | PROJECT 10-050, 16-009 | 50,000.00   | 0.00     | 50,000.00   |
| Totals:        |              |                        | 52,500.00   | 0.00     | 52,500.00   |